



# City of Napoleon, Ohio

## Zoning Department

255 West Riverview Avenue, P.O. Box 151

Napoleon, OH 43545

Kevin Schultheis Code Enforcement/ Zoning Administrator

Telephone: (419) 592-4010 Fax: (419) 599-8393

[www.napoleonohio.com](http://www.napoleonohio.com)

### RESIDENTIAL ZONING PERMIT

Issued Date: November 16, 2021

Expiration Date: November 16, 2022

Permit Number: P-21-231

Job Location: 1231 Detroit Avenue

Owner: Nick and Jennifer Sosebee  
1231 Detroit Avenue  
Napoleon, Ohio 43545

Contractor: Everdry Waterproofing

Zone: R-4 High Density Residential

Set Backs: Principle Building

Front: 25 Rear: 15 Side: 7

Comments:  
Basement Waterproofing

Permit Type: Zoning

Fee: \$25.00

Status: Paid

Amount Due: \$0.00

Kevin Schultheis  
Code Enforcement / Zoning Administrator



# City of Napoleon, Ohio

## Zoning Department

255 West Riverview Avenue, P.O. Box 151  
 Napoleon, OH 43545  
 Kevin Schultheis Code Enforcement / Zoning Administrator  
 Telephone: (419) 592-4010 Fax: (419) 599-8393  
 www.napoleonohio.com

P-21-231  
R-4

### Residential Zoning Permit Application

Date 11-16-21 Job Location 1231 Detroit Ave

Owner Nick & Jennifer Sosbee Telephone # 419-966-0475

Owner Address 1231 Detroit Ave

Contractor Emedy waterproofing Cell Phone # 419-841-6055

Description of Work to be Performed Basement waterproofing

Estimated Completion Date 11-16-22 Estimated Cost 19,000

Demo Permit - \$100.00 – See Separate Form	(MDEMO 100.1700.46690)	\$
Zoning Permit - \$25.00	(MZON 100.1700.46690)	\$
Fence/Pool/Deck - \$25.00	(MZON 100.1700.46690)	\$
Accessory Building 200 SF or less (Detached) - \$25.00	(MZON 100.1700.46690)	\$
Driveway/Sidewalk/Curbing/Patio - \$0.00	(MZON 100.1700.46690)	\$
Drainage Permit/Outside Water/Sewer Repair - \$0.00	(MBLDG 510.0000.44730)	\$
1" Water Tap, 5/8" Meter, Copper Setter and Transmitter - \$1,200.00(Outside City - \$5,680)	(MBLDG 510.0000.44730)	\$
1" Water Tap, 3/4" Meter, Copper Setter and Transmitter - \$1,300.00(Outside City - \$5,820)	(MBLDG 510.0000.44730)	\$
1" Water Tap, 1" Meter, Copper Setter and Transmitter - \$1,400.00 (Outside City - \$5,960)	(MBLDG 510.0000.44730)	\$
1" Meter, Copper Setter and Transmitter Without Tap - \$525.00	(MBLDG 510.0000.44730)	\$
3/4" Meter, Copper Setter and Transmitter Without Tap - \$440.87	(MBLDG 510.0000.44730)	\$
5/8" Meter, Copper Setter and Transmitter Without Tap - \$350.00	(MBLDG 510.0000.44730)	\$
Sewer Tap For Lots 7,200 Sq. Ft. Or Less - \$0.00	(MBLDG 520.0000.44830)	\$
Sewer Tap For Lots (Single Family) 7,201 To 12,199 Sq. Ft. ( x \$0.012)	(MBLDG 520.0000.44830)	\$
Sewer Tap For Lots (Single Family) 12,200 Sq. Ft. or Greater - \$60.00	(MBLDG 520.000.44830)	\$
Sewer Tap For Lots (Two Family) 7,201 to 23,866 Sq. Ft. ( x\$0.012)	(MBLDG 520.0000.44830)	\$
Sewer Tap For Lots (Two Family) 23,867 Sq. Ft. or Greater - \$200.00	(MBLDG 520.0000.44830)	\$
Sewer Tap For Lots (Three Family) 7,201 to 36,366 Sq. Ft. ( x\$0.012)	(MBLDG 520.0000.44830)	\$
Sewer Tap For Lots (Three Family) 36,367 Sq. Ft. or Greater - \$350.00	(MBLDG 520.0000.44830)	\$
Sewer Tap Inspection Fee For Single Family or Duplex - \$60.00	(MBLDG 520.0000.44830)	\$
Inspection Fee Outside the Corporation Limits - Increase 50%	(MBLDG 520.0000.44830)	\$
<b>TOTAL FEE:</b>		\$

**I FULLY UNDERSTAND THAT NO EXCAVATION, CONSTRUCTION OR STRUCTURAL ALTERATION, ELECTRICAL OR MECHANICAL INSTALLATION OR ALTERATION OF ANY BUILDING STRUCTURE, SIGN, OR PART THEREOF AND NO USE OF THE ABOVE SHALL BE UNDERTAKEN OR PERFORMED UNTIL THE PERMIT APPLIED FOR HEREIN HAS BEEN APPROVED AND ISSUED BY THE CITY OF NAPOLEON ZONING DEPARTMENT.**  
 I hereby certify that I am the Owner of the named property, or that the proposed work is authorized by the Owner of record and that I have been authorized by the Owner to make this application as his/her authorized agent and I agree to conform to all applicable laws of the jurisdiction. In addition, if a permit for Work described in this application is issued, I certify that the code official or the code official's authorized representative shall have the authority to enter areas covered by such permit at any reasonable hour to enforce the provisions of the code(s) applicable to such permit.  
**I HEREBY ACKNOWLEDGE THAT I HAVE READ AND FULLY UNDERSTAND THE ABOVE LISTED INSTRUCTIONS.**

SIGNATURE OF APPLICANT: [Signature] DATE: 11-16-21

BATCH #	CHECK #	DATE
---------	---------	------

Per Rule 10.2 of the City of Napoleon Rules for Water and Sewer Service, City personnel will assist property owners in locating existing sanitary sewer laterals and water services to the best of their ability. However, the City does not guarantee the accuracy of said markings and is not liable for any expense incurred by the property owner if said markings are incorrect.



# EVERDRY WATERPROOFING

219  
501

11/18/11  
DR  
BACTA

## WORK CARD

SNS

WSD  
WSD

Phase 1 - EZB Date

12/19 7/30/10

Scheduled Start Date

2/29/11

Confirmed H W

Customer's Name Nick + Jennifer Sosbee

Customer's Address 1231 Detroit Ave.

City State Zip Napoleon, Ohio

Primary Phone # 419-966-0475

Secondary Phone # 419-966-7997

Primary E-mail

Secondary E-mail

Roads / Landmarks

### URGENT: FOR OFFICIAL PROCESSING

Inspector Jeremy H Production Supervisor Tim

Order Processor Melissa Melby Materials Drop Ship

Office Mgr. Gil Foreman

BHA Certified Tony Quality Control Jeremy J.

# The No.1 Choice

PA

Handwritten notes and stamps at the bottom of the page, including "K... 132K" and "Panone/..."

CIRCLE - Best water

**INSIDE AREA**

- Bare
- Finished
  - Panel
  - Drywall
  - Carpet
  - Floor Tiles
- Appliances/Features  
(Indicate location on drawing)
  - Washer/Dryer
  - Sink
  - Toilet
  - Shower
  - Furnace
  - H<sub>2</sub>O Tank
  - Fuel Oil Tank
  - Exist. Sump
  - Well Pump and Tank
  - Softener

**OUTSIDE AREA**

- Landscaping
- Deck
- Bushes
- Trees

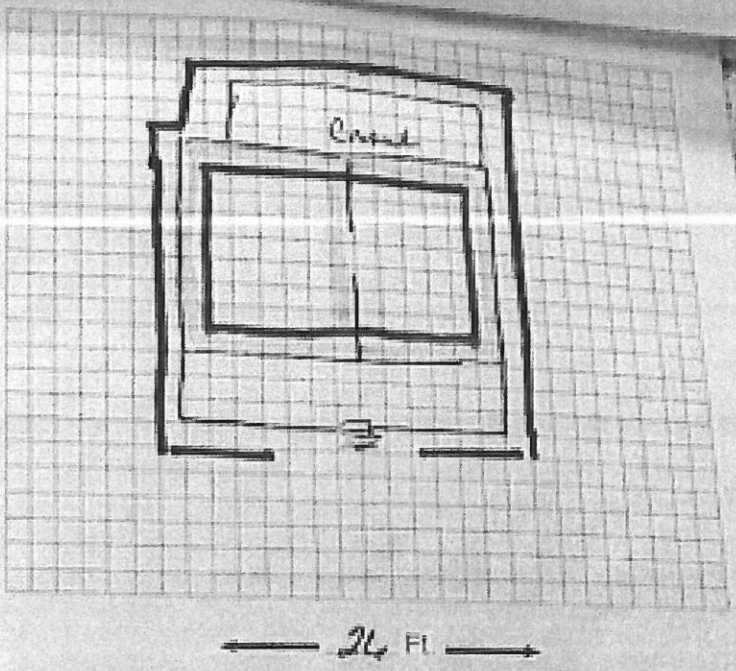

Drawing Designed and Reviewed By:

Rep J. H. Cust. *(ANS)* Cust.

Inside System -Red    Outside Sub-Sol -Green    STABWALL™ -Blue    Durashield™ -Yellow

**IMPORTANT NOTE:**

Termination point for Pressure Relief Pump is at Foreman's discretion. Possibilities include: surface, hill swale, storm drain (if access at house) or any other that is in accordance with local codes.

Initial *(ANS)*

**NOTES TO FOREMAN - SPECIAL INSTRUCTIONS**

Initial All

(Reasons To Fix) *Useable Space*

1. *Use Side Door Entrance.*
2. *We will put Doors on Inside wall of Room.*
3. *Take out Small Bushes on Side of House.*

*(ANS)*

Investment *19,000*    Deposit *500* *OK*